

Guidance for Bridger View Homeowners: Air Barrier Penetrations

Issued: 6 November 2024

This document provides guidance on maintaining the integrity of the attic air barrier in the case of renovations or other activities that may compromise the air barrier.

Background

Your home is constructed with vented attic spaces that include loose-blown insulation in the bottom of the roof trusses, as shown in this architectural detail (some conditions vary):

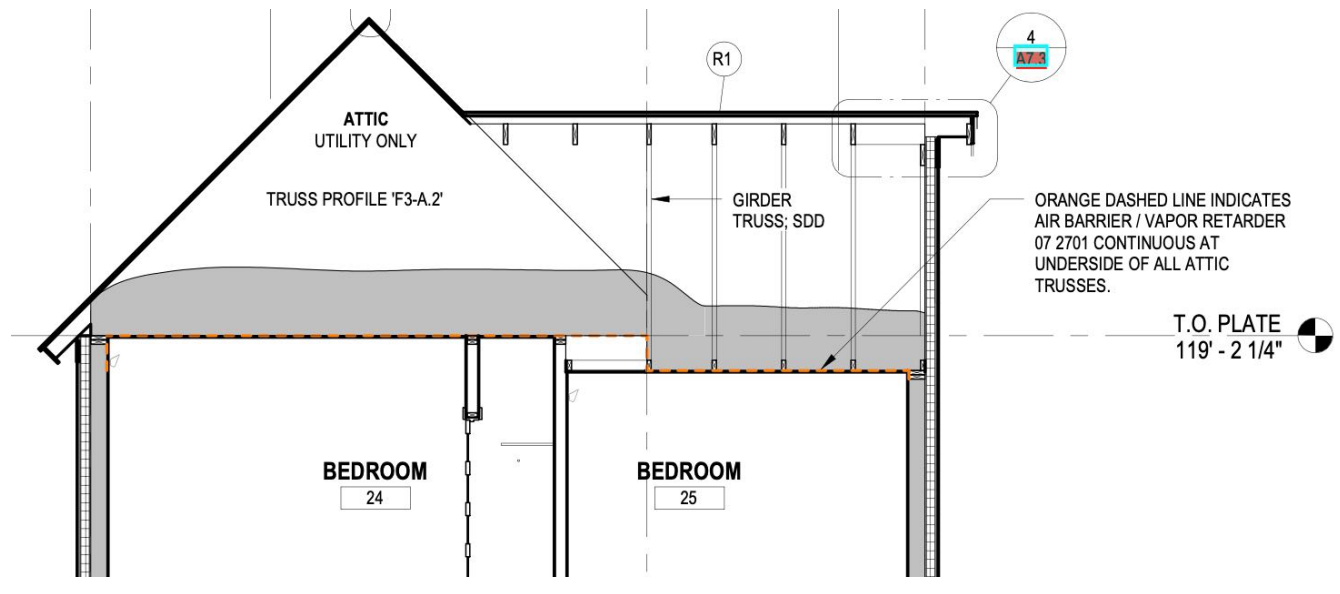

A continuous air barrier membrane exists between the ceiling drywall and bottom of the roof trusses as shown above by the dashed orange line. During construction, contractors used special tapes to overlap adjacent pieces of the Pro Clima INTELLO Plus membrane and seal it to wall top plates as shown in this photo.

Recommendations

To minimize heat loss, utility bills for space heating, and roof ice dams, *it's very important to maintain the integrity of the air barrier membrane*. This includes:

1. Minimizing penetrations when other options exist (e.g. avoid installing can lights)
2. Sealing the membrane to any new equipment that penetrates the air barrier (e.g. junction boxes or registers from new HVAC ductwork)

The primary material used in your home is Tescon Vana tape, which can be ordered from [475 Building Supply](#):



Other tapes that are compatible with the Pro Clima membrane and most other substrates, and are typically available from local suppliers, include:

- 3M All-Weather Flashing Tape
- ZIP System Flashing Tape

If a new penetration must be made, cut through the membrane with an "X" pattern so that the membrane can easily be folded back to accommodate the penetration. Then, trim the excess membrane flaps while leaving enough material to wrap over the equipment, duct, or pipe and tape.

Note that relying on canned spray foam for air sealing is unreliable. We recommend tape as the best solution. In some cases, standard acoustic caulk may be appropriate for very small penetrations smaller than ¼" in diameter, as well as locations where tape is challenging to fully cover (such as corners).

– END –